









Sample image

Datasheet

Article number: 70004128
Designation: CA10B.A213.GK1
Description: Switch

IEC 60947-3 EN 60947-3, VDE 0660 Teil 107						
Märkdriftspänning Ui						
<i>Spänning (V) AC / DC</i>						
690 AC / DC						
Märkdriftström vid konstant drift						
<i>Ström (A)</i>	<i>Omgivningstemperatur (°C)</i>	<i>Temperatur topp (°C) ytterligare krav</i>				
20	55	60 Omgivningstemperatur +55°C under 24 timmar med toppar upp till +60°C				
Märkdriftström Ie						
<i>Urvals kriterie</i>						
				<i>Spänning (V)</i>	<i>Ström (A)</i>	
AC-15				220 - 240	6	
AC-15				380 - 440	4	
Märkdrifteffekt						
<i>Urvals kriterie</i>						
	<i>Spänning (V)</i>	<i>No. of phases</i>		<i>No. of poles</i>		<i>Effekt (kW)</i>
AC-3	220 - 240	3		3		3
AC-3	380 - 440	3		3		5,50
AC-3	660 - 690	3		3		5,50
AC-3	220 - 240	1		2		2,20
AC-3	380 - 440	1		2		3
AC-23A	220 - 240	3		3		3,70
AC-23A	380 - 440	3		3		7,50
AC-23A	660 - 690	3		3		7,50
AC-23A	220 - 240	1		2		2,50
AC-23A	380 - 440	1		2		3,70
Max försäkring, IEC						
<i>Säkringskarakteristik</i>						
gG				<i>Antal säkringar</i>		<i>Ström (A)</i>
				1		25
UL60947-4-1 , UL508						
Nominal Voltage						
<i>Spänning (V) AC / DC</i>						
300 AC / DC						
Märkdriftspänning Ui						
<i>Spänning (V) AC / DC</i>						
300 AC						
Rated thermal current						
<i>Ström (A)</i>						
20						
<i>Omgivningstemperatur (°C) Additional Text</i>						
0 - 40 --						
Horsepower rating						
<i>Across-the-Line Motor Starting</i>						
	<i>Spänning (V)</i>	<i>No. of phases</i>	<i>No. of poles</i>	<i>Power (HP)</i>	<i>Ambient temperature [°C]</i>	
Reversing	110 - 120	1	2	0,17	40	
Reversing	220 - 240	1	2	0,50	40	
Reversing	277 - 277	1	2	0,60	40	
Reversing	110 - 120	3	3	0,50	40	
Reversing	220 - 240	3	3	1	40	
DOL	110 - 120	1	2	0,50	40	
DOL	220 - 240	1	2	1	40	
DOL	277 - 277	1	2	2	40	
DOL	110 - 120	3	3	1,50	40	
DOL	220 - 240	3	3	3	40	
Pilot duty rating code						
<i>Duty Code</i>						
A300						
SCCR / Max. fuse rating						
<i>Conditions of acceptability</i>						
These devices are suitable for use on circuits capable of delivering not more than 5000 rms symmetrical amperes, 600V ac max. when protected by Class RK1 fuses. Manual Motor Controllers when intended for use as a motor disconnect are suitable for use on a circuit capable of delivering not more than 5000 rms symmetrical amperes, 600V ac max. when protected by 30A Class J time delay fuses.						
Temp. rating of wire						
<i>Temperature rating (°C)</i>						
60 - 75						
<i>Ström (A) Text</i>						
-- Use copper wire only						
Connecting instructions						
<i>Markings</i>						
När brytaren används som säkerhetsbrytare skall den vara utrustad med vred som är låsbart i läge "0".						

General Use								
AC / DC	Spänning (V)	Ström (A)	No. of phases	No. of poles	No. of contacts in series			
AC	300	20	1	2	1			
AC	300	20	3	3	1			
CSA								
Nominal Voltage								
				Spänning (V) AC / DC				
				300 AC				
Märkdriftspänning Ui								
				Spänning (V) AC / DC				
				300 AC				
Rated thermal current								
		Ström (A)	Omgivningstemperatur (°C)		Additional Text			
		20	0 - 40		-			
Horsepower rating								
Across-the-Line Motor Starting				Spänning (V)	No. of phases	No. of poles	Power (HP)	Ambient temperature [°C]
DOL				110 - 120	1	2	0,50	40
DOL				220 - 240	1	2	1	40
DOL				277 - 277	1	2	2	40
DOL				110 - 120	3	3	1,50	40
DOL				220 - 240	3	3	3	40
Pilot duty rating code								
Duty Code								
A300								
Temp. rating of wire								
				Temperature rating (°C)	Ström (A) Text			
				75	-			
General Use								
AC / DC	Spänning (V)	Ström (A)	No. of phases	No. of poles	No. of contacts in series			
AC	300	20	1	1	1			
GENERAL TECHNICAL INFORMATION								
Size of conductor								
composition of conductor	Min. / Max. value	No. of conductor per terminal		Cross section (mm ²) or (AWG/kcmil)		Material of the wire		
flexible wire	Max.			2 2,5mm ²		Copper		
flexible wire	Max.			2 AWG 14		Copper		
Single-core or stranded wire	Max.			2 AWG 12		Copper		
Single-core or stranded wire	Max.			2 2,5mm ²		Copper		
flexible wire with ferrule according to DIN 46228	Max.			2 2,5mm ²		Copper		
Stripping length								
				Length (mm) --				
								
Rekomenderad skruvmejsel								
Typ av skruvmejsel				Value				
Stjärnskruvmejsel				PH1				
Slot screwdriver according to DIN 5264				0,8x4				
Tightening torque of screws								
				tightening torque (Nm)	tightening torque (lb-in)			
				0,60	5			
Approbations								
Specification						Marking		
EAC								
CE marking								
UK Directives								
CSA C.22.2 No.14								
GB/T14048.3								
General Information								
Text								
<ul style="list-style-type: none"> - Smörjning och behandling av kontakterna är förbjuden. - Inkoppling och service av strömställaren får endast utföras av behörig personal. Strömställaren är underhållsfri. - Använd endast kopparkabel. Kabeln får inte förtennas. - Alla anslutningsskruvar måste dras med rekommenderat moment, även de som inte används då det kan finnas interna överkopplingar. - Vid installation av strömställaren skall kontrolleras att kryp- och luftavstånd motsvarar gällande föreskrifter. 								
Waste Electrical & Electronic Equipment (WEEE)								
Picture name	Description							
	Do not throw in the trash as care must be taken to ensure environmentally sound disposal and recycling. Please either use an environmentally friendly waste disposal company; return to the supplier for disposal; or return direct to the manufacturer, Kraus & Naimer. You can find local Kraus & Naimer offices at www.krausnaimer.com							

Proposition 65

Picture name Description

 WARNING: This product can expose you to chemicals including nickel and lead, which is known to the State of California to cause cancer. For more information go to www.P65Warnings.ca.gov.

Classification Contact: Rigid contact bridge

Classification Contact Mat: Silver

Classification Terminal: Screw terminal

Mounting-GK1

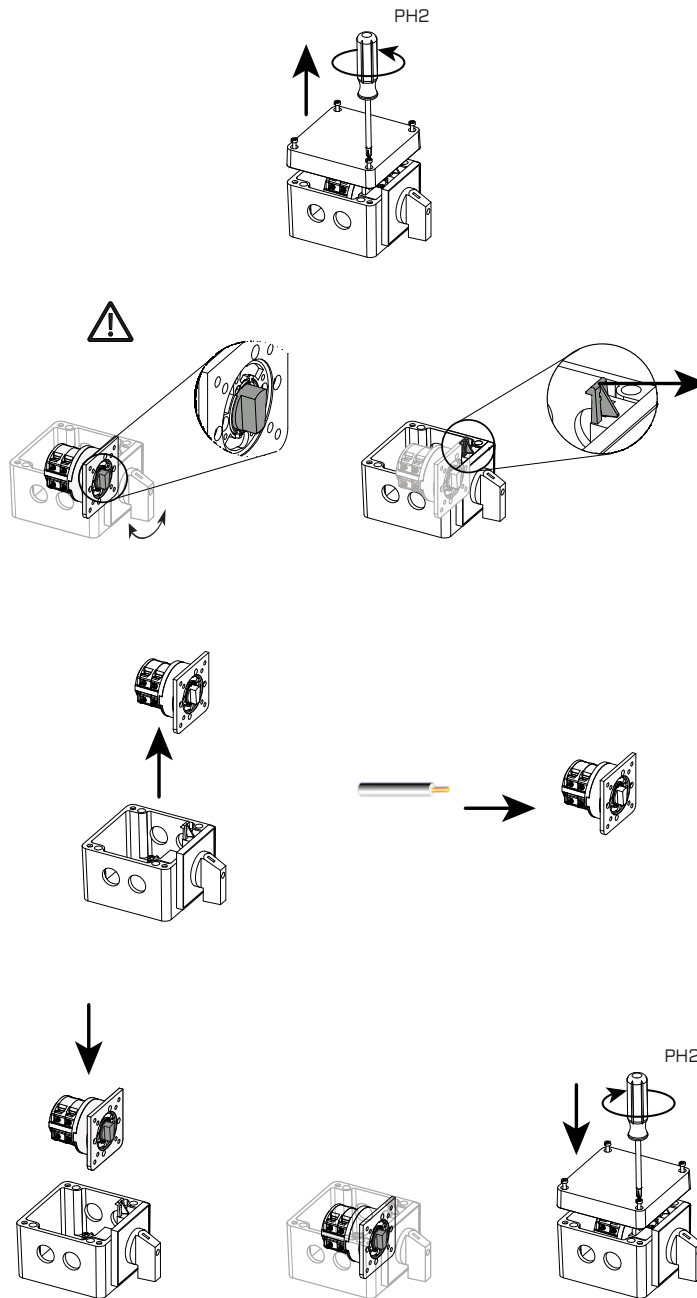

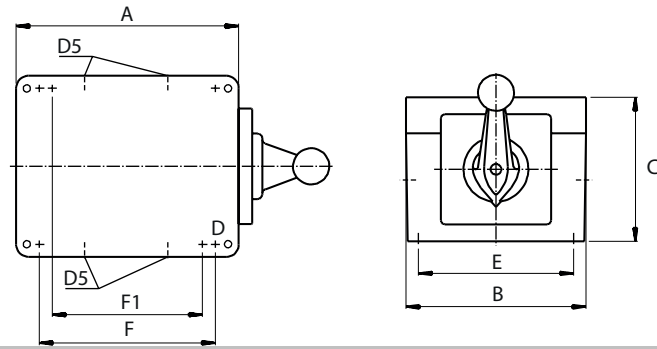

Skyddsklass frontpanel, IP		IP65
Stages		1,00 - 4,00
A	H	100,00 mm
B	H	100,00 mm
C	H	80,00 mm
D	Ø	4,80 mm
D5	Ø	4,00 x M20
E	H	86,00 mm
F	H	66,00 mm

Wiring diagram

CA10B.A213.GK1

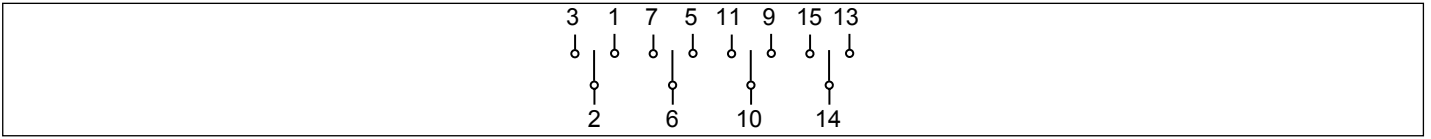

Switch program

CA10B.A213.GK1

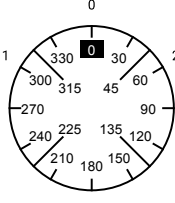
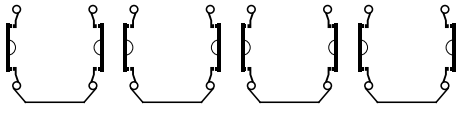
 Kraus & Naimer		CA10B	A213	Page 1 of 1											
Face Plate															
		1	3	5	7	9	11	13	15	17	19	21	23		
															
Switching Angle <input type="text" value="60"/> Total switching Angle <input type="text" value="120"/>		2	4	6	8	10	12	14	16	18	20	22	24		
1	300		■		■		■		■						
	315														
	330														
	345														
0	0														
	15														
	30														
	45														
2	60	■		■		■		■							
	75														
	90														
	105														
	120														
	135														
	150														
	165														
	180														
	195														
	210														
	225														
	240														
	255														
	270														
	285														

Version: 93

Face plate

S1.F071/A1B.PEL

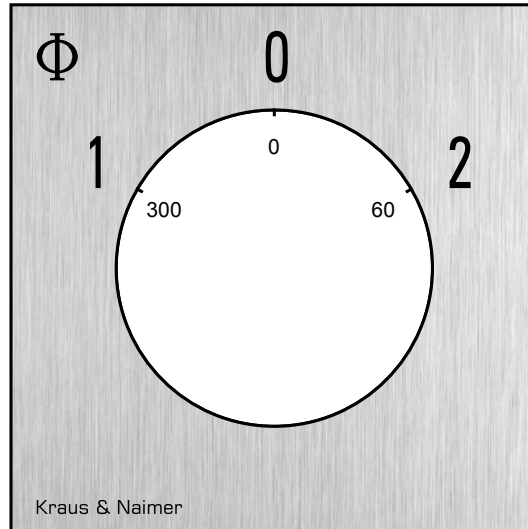

HANDLES

Designation: S1B.G251
Handle colour: "1" black

